

QUARTER CIRCLE ORIFICE PLATE

Recommended for viscous fluids

GENERAL DATA

- Standard: ISO/TR 15377
- Flange mounting⁽¹⁾:
 - o ISO PN 2.5 to PN 420
 - o ASME 150# to 2500#
 - o Others: upon request
- Material:
 - o Standard: stainless steel 304L / 316L
 - o Others⁽¹⁾: according to your application
- Fluid: liquid, gas, steam
- Pipes from ϕ 25 to 500 mm
- Accuracy: 2 % of the max flow rate
- Repeatability of measurement: 0.1 %



pressure taps⁽¹⁾

$D \geq 40$ mm

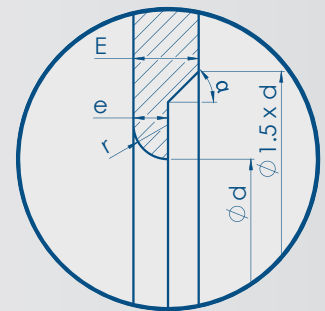
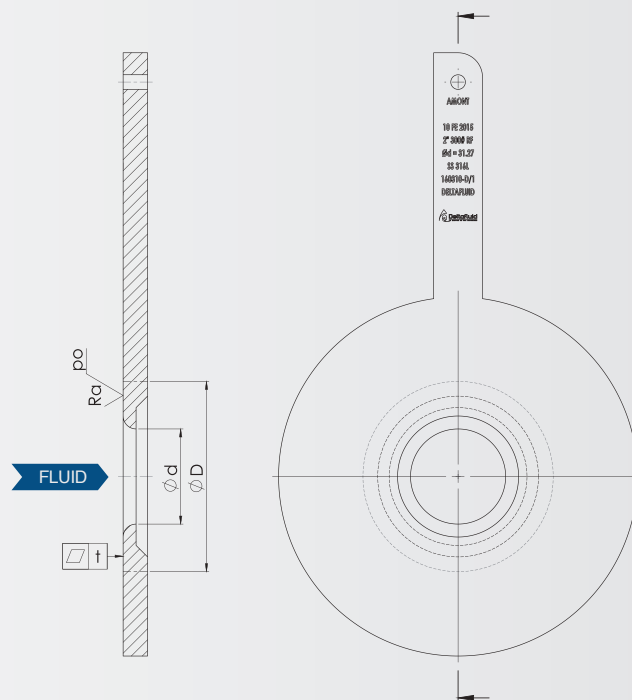

Optional: stellite coating⁽¹⁾

TECHNICAL CHARACTERISTICS

		ISO/TR 15377
Re_D	Reynolds number in the pipe	$250 \leq Re_D \leq 6 \cdot 10^4$
D	Inside pipe diameter	$25 \text{ mm} \leq D \leq 500 \text{ mm}$
d	Orifice diameter	$d \geq 15 \text{ mm}$
β	d/D	$0.245 \leq \beta \leq 0.6$
Ra	Upstream face roughness	$Ra \leq 10^{-4} \cdot d$
r	Quarter circle radius	$0.100 \cdot d \leq r \leq 0.207 \cdot d$
e	Quarter circle orifice thickness	$2.5 \text{ mm} \leq e \leq 0.1 \cdot D$
E	Plate thickness	$E \geq r$
α	Angle of the downstream bevel if needed	$\alpha = 45^\circ$
t	Flatness tolerance	Contact us

⁽¹⁾ For more details, see «Technical information» section on page 54.